

Block 28

Bunny Hill Designs

Supplies & Cutting

Dark: (9" x 22")

1-3 7/8" x 3 7/8" square

cut the 1-3 7/8" square once on the diagonal
to make 2 triangles

4-2" x 2" squares

Medium: (9" x 22")

1-3 7/8" x 3 7/8" square

cut the 1-3 7/8" square once on the diagonal
to make 2 triangles

4-2" x 2" squares

Light: (9" x 22")

1-3 7/8" x 22" strip

cut the 1 strip into 2-3 7/8" x 3 7/8" squares

1-3 1/2" x 3 1/2" square

cut the 2-3 7/8" squares once on the diagonal
to make 4 triangles

1-3 1/2" x 22" strip

cut the 1 strip into 8-3 1/2" x 2" rectangles

Use a 1/4" seam allowance.

Press in the direction of the arrows.

Quilt Construction

Draw a diagonal line on the wrong side of
4-2" x 2" Medium squares and 4-2" x 2" Dark squares.

- 1 (A) Layer, right sides together, 1-2" x 2" Medium square on 1-3 1/2" x 2" Light rectangle as shown. Sew on the diagonal line. Trim 1/4" from the diagonal line. Press to the corner to form the triangle. Repeat on the other side using 1-2" x 2" Dark square. Make 2.

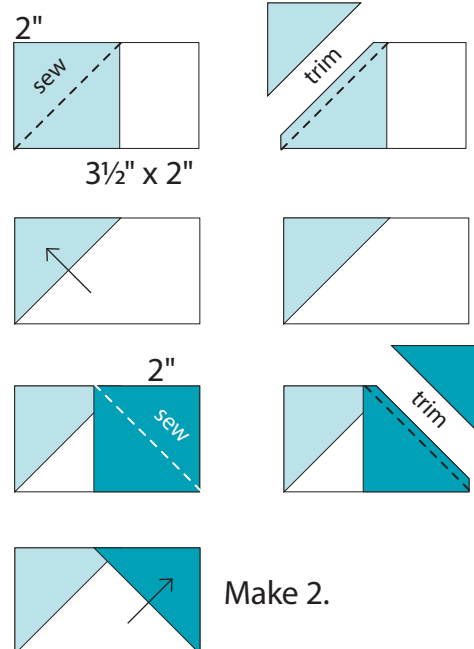

- (B) Repeat reversing the position of the Medium and Light squares.

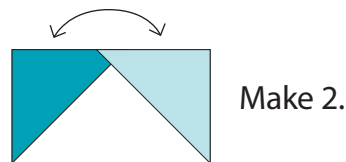

- (C) Add 1-3 1/2" x 2" Light rectangle to the previous units.

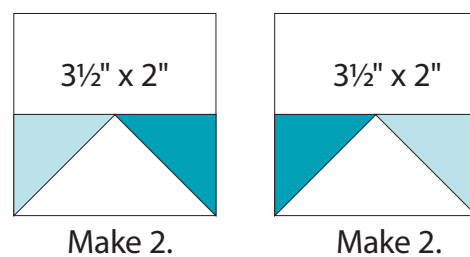

3 1/2" x 3 1/2" with seams

2 Using your favorite method make $3\frac{1}{2}$ " of $\frac{1}{4}$ " bias for each Basket handle. Glue-baste to the $3\frac{7}{8}$ " Light triangles following template. Appliqué in place. Sew $1-3\frac{7}{8}$ " x $3\frac{7}{8}$ " Dark triangle to the Medium Handle and $1-3\frac{7}{8}$ " x $3\frac{7}{8}$ " Medium triangle to the Dark Handle. Make 2 of each.

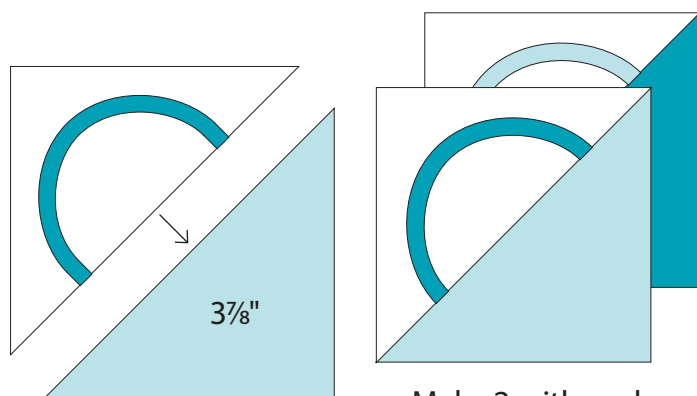
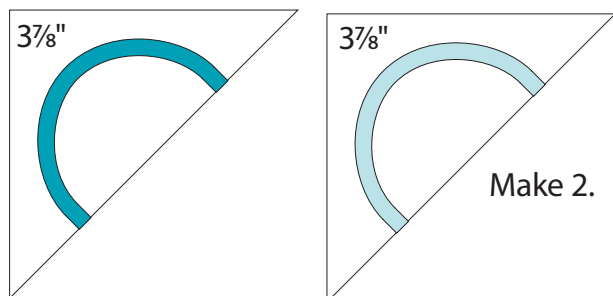

Make 2 with each
Handle.
 $3\frac{1}{2}$ " x $3\frac{1}{2}$ "
with seams

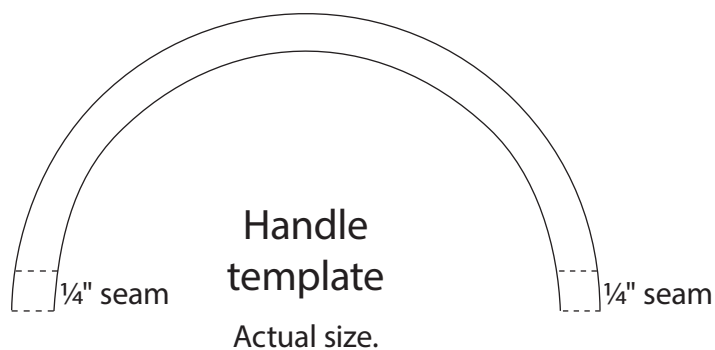

3 Assembly: Sew the block parts into rows as shown. Press in the direction of the arrows. Combine the rows.

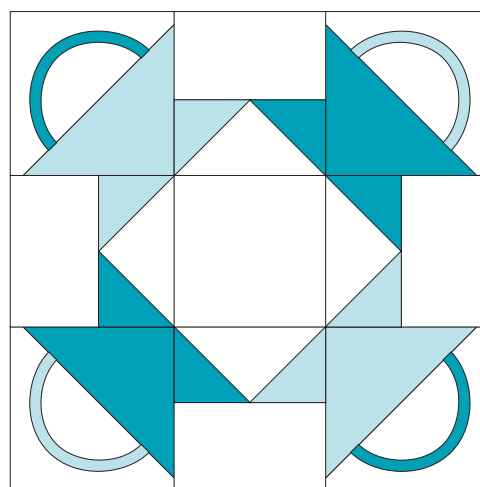
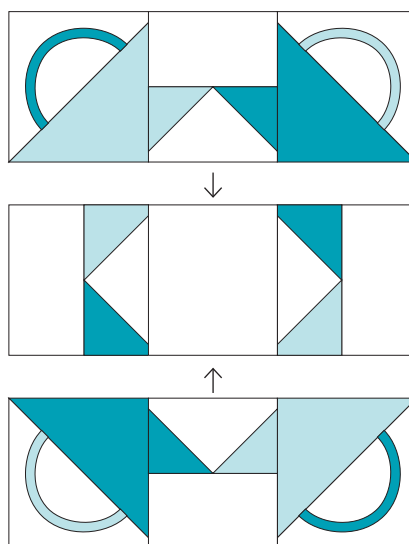
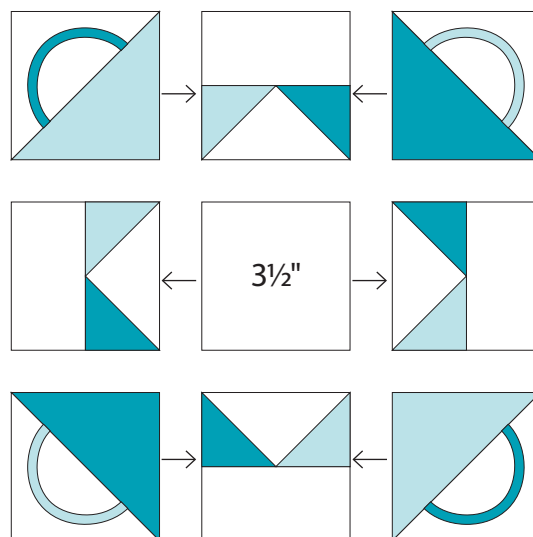

$9\frac{1}{2}$ " x $9\frac{1}{2}$ " with seams